

DIN 608 120° (8.8, 10.9)

Plough bolts with square neck - 120° head, with nuts DIN 934 (8.8)

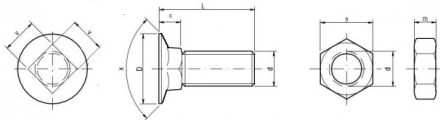

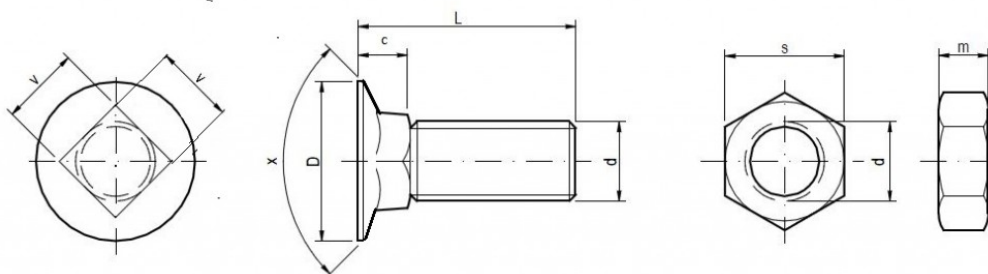

Specifications

d	c	D	x	v	s	m
M 12	7,00	19,50	120°	12,00	19,00	10,00
M 14	9,60	22,00	120°	14,00	22,00	11,00

Packaging

Packed in boxes / pcs		Packaging without nuts	Packaging with nuts
12 x 30	DIN 608 120° (8.8, 10.9)	100	100/100
12 x 35	DIN 608 120° (8.8, 10.9)	100	100/100
12 x 40	DIN 608 120° (8.8, 10.9)	150	100/100
12 x 45	DIN 608 120° (8.8, 10.9)	150	100/100
12 x 50	DIN 608 120° (8.8, 10.9)	100	50/50
12 x 55	DIN 608 120° (8.8, 10.9)	100	50/50
12 x 60	DIN 608 120° (8.8, 10.9)	100	50/50
12 x 65	DIN 608 120° (8.8, 10.9)	90	50/50
12 x 70	DIN 608 120° (8.8, 10.9)	80	50/50
12 x 75	DIN 608 120° (8.8, 10.9)	80	50/50
12 x 80	DIN 608 120° (8.8, 10.9)	60	50/50
14 x 30	DIN 608 120° (8.8, 10.9)	50	50/50
14 x 35	DIN 608 120° (8.8, 10.9)	50	50/50
14 x 40	DIN 608 120° (8.8, 10.9)	50	50/50
14 x 45	DIN 608 120° (8.8, 10.9)	50	50/50

14 x 50	DIN 608 120° (8.8, 10.9)	50	50/50
14 x 55	DIN 608 120° (8.8, 10.9)	50	50/50
14 x 60	DIN 608 120° (8.8, 10.9)	50	50/50
14 x 65	DIN 608 120° (8.8, 10.9)	50	50/50
14 x 70	DIN 608 120° (8.8, 10.9)	50	50/50
14 x 75	DIN 608 120° (8.8, 10.9)	50	50/50
14 x 80	DIN 608 120° (8.8, 10.9)	50	50/50