

ISO 5713 (8.8, 10.9)

Plough bolts with 2 nibsand, with nuts DIN 934 (8.8)

THE MOST PARTICULAR USE

The bolts to machinery of KVERNELAND

The most often used code OEM Kverneland KK033107 12 x 35

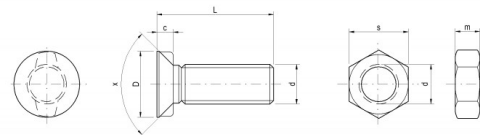

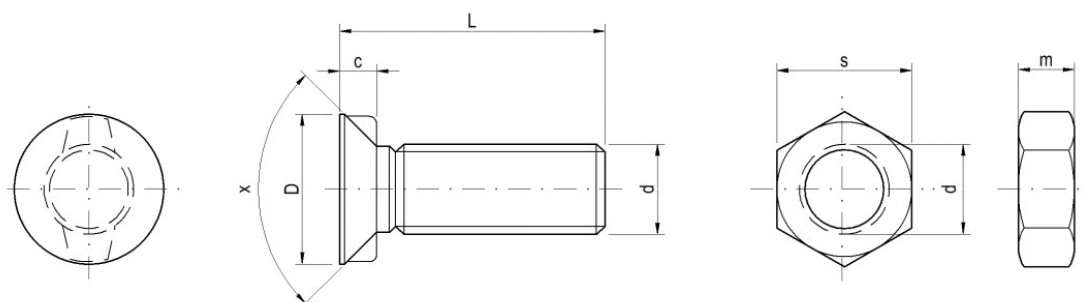

Specifications

d	c	D	x	s	m
M 10	4,50	16,00	90°	17,00	8,00
M 12	5,50	20,00	90°	19,00	10,00
M 14	7,00	24,00	90°	22,00	11,00

The bolts ISO 5713 do fit to machinery of OEM KVERNELAND, ÖVERUM, PÖTTINGER, LANDSBERG, NIEMEYER, RABE, OVLAC, KÖCKERLING, FARMET, BEDNAR, ROSS, PHX, UNIA GRUDZIADZ, OPALL AGRI, and many others.

Packaging

Packed in boxes / pcs		Packaging without nuts	Packaging with nuts
10 x 25	ISO 5713 (8.8, 10.9)	200	150/150
10 x 30	ISO 5713 (8.8, 10.9)	150	100/100
10 x 35	ISO 5713 (8.8, 10.9)	150	100/100
10 x 40	ISO 5713 (8.8, 10.9)	100	100/100
10 x 45	ISO 5713 (8.8, 10.9)	100	50/50
10 x 50	ISO 5713 (8.8, 10.9)	100	50/50
10 x 55	ISO 5713 (8.8, 10.9)	100	50/50
10 x 60	ISO 5713 (8.8, 10.9)	150	100/100
10 x 70	ISO 5713 (8.8, 10.9)	150	100/100

10 x 80	ISO 5713 (8.8, 10.9)	100	50/50
10 x 90	ISO 5713 (8.8, 10.9)	80	50/50
12 x 30	ISO 5713 (8.8, 10.9)	100	50/50
12 x 35	ISO 5713 (8.8, 10.9)	100	50/50
12 x 37	ISO 5713 (8.8, 10.9)	100	50/50
12 x 40	ISO 5713 (8.8, 10.9)	150	100/100
12 x 45	ISO 5713 (8.8, 10.9)	150	100/100
12 x 50	ISO 5713 (8.8, 10.9)	100	100/100
12 x 55	ISO 5713 (8.8, 10.9)	100	50/50
12 x 60	ISO 5713 (8.8, 10.9)	90	50/50
12 x 70	ISO 5713 (8.8, 10.9)	80	50/50
12 x 80	ISO 5713 (8.8, 10.9)	60	50/50
12 x 90	ISO 5713 (8.8, 10.9)	50	50/50
12 x 100	ISO 5713 (8.8, 10.9)	50	50/50
14 x 30	ISO 5713 (8.8, 10.9)	50	50/50
14 x 35	ISO 5713 (8.8, 10.9)	50	50/50
14 x 40	ISO 5713 (8.8, 10.9)	50	50/50
14 x 42	ISO 5713 (8.8, 10.9)	50	50/50
14 x 45	ISO 5713 (8.8, 10.9)	50	50/50
14 x 50	ISO 5713 (8.8, 10.9)	50	50/50
14 x 55	ISO 5713 (8.8, 10.9)	50	50/50
14 x 60	ISO 5713 (8.8, 10.9)	50	50/50
14 x 70	ISO 5713 (8.8, 10.9)	50	50/50
14 x 80	ISO 5713 (8.8, 10.9)	50	50/50