

MP - 2 IT (12.9)

Plough bolts with conical head with nuts DIN 934 (10.9)

THE MOST PARTICULAR USE

The bolts to machinery of KVERNELAND

The most often used bolt - 12 x 37

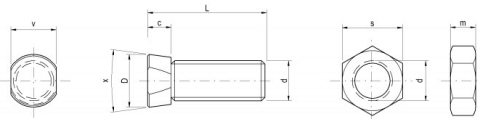

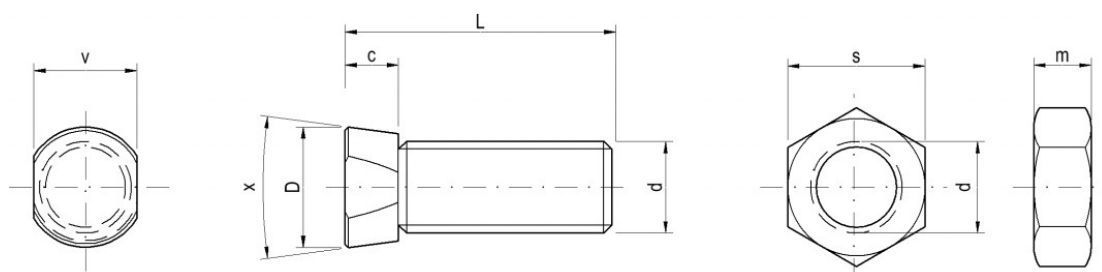

Specifications

d	c	D	x	v	s	m
M 12	7,00	16,00	10°	14,00	19,00	10,00

The bolts MP - 2 G do fit to machinery of OEM KVERNELAND, ÖVERUM, PÖTTINGER LANDSBERG, LEMKEN, NIEMEYER, RABE, OVLAC, KÖCKERLING, FARMET, BEDNAR, ROSS, PHX, UNIA GRUDZIADZ, OPALL AGRI and many others.

Packaging

Packed in boxes / pcs		Packing without nuts	Packing with nuts
12 x 37	MP - 2 IT 12.9	100	50/50