

MP - 21 (10.9)

Bolts with mushroom head with feather with nuts DIN 934 (8.8)

THE MOST PARTICULAR USE

The bolts for self propelled mixers

The most often used bolt - 12 x 42

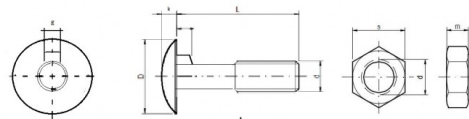

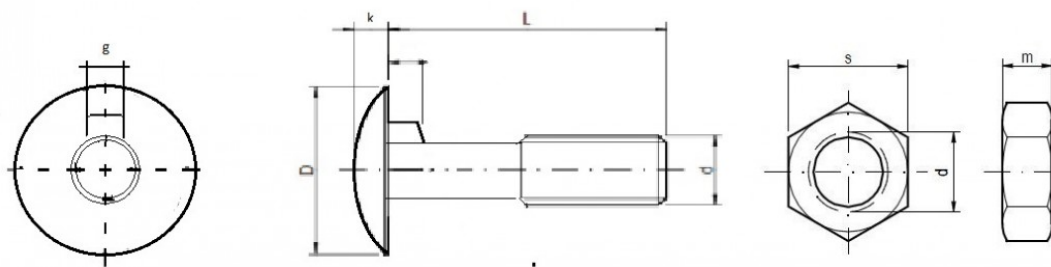

Specifications

d	c	D	g	k	s	m
M 12	4,75	24,00	6,80	5,30	19,00	10,00

The bolts MP - 21 do fit to self propelled mixers of OEM STORTI,FARESIN and many others

Packaging

Packed in boxes / pcs		Packaging without nuts	Packaging with nuts
12 x 42	MP - 21 (10.9)	100	100/100