

## **RABE OVAL K (10.9, 12.9)**

**Plough bolts with conical head, with nuts DIN 934 (8.8, 10.9)**

### **THE MOST PARTICULAR USE**

The bolts to machinery of RABE

The most often used bolt - 12 x 35

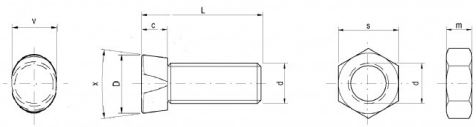

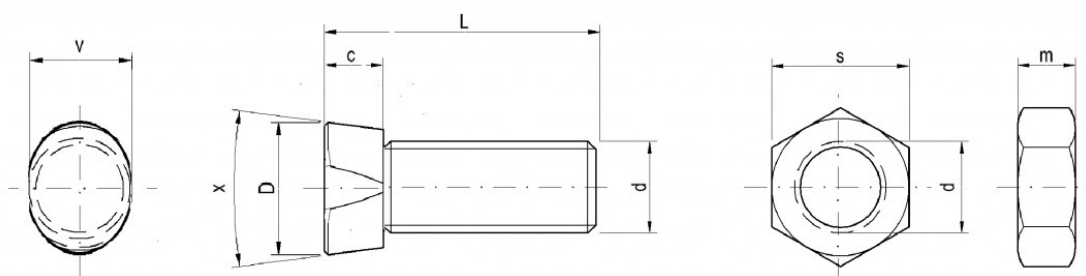

## Specifications

d	c	D	x	v	s	m
M 12	8,50	18,00	18°	14,00	19,00	10,00

The bolts RABE OVAL do fit to machinery of OEM RABE

## Packaging

Packed in boxes / pcs		Packing without nuts	Packing with nuts
12 x 30	Rabe Oval K (10.9, 12.9)	150	100/100
12 x 35	Rabe Oval K 10.9, 12.9	150	100/100
12 x 37	Rabe Oval K 10.9, 12.9	100	50/50
12 x 40	Rabe Oval K 10.9, 12.9	100	50/50
12 x 45	Rabe Oval K 10.9, 12.9	100	50/50